

User Manual

Step-by-Step Communicator⁷⁵

an

AbleLink™
c o n n e c t a b l e s

Product



Step-by-Step Communicator⁷⁵

This user manual will introduce you to the Step-by-Step Communicator⁷⁵ and provide quick reference for its operation. Please read it completely and keep it for future reference. We welcome your comments and suggestions regarding this and any other AbleNet products, literature or services.

Battery Installation

1. Remove the mounting base (if attached) by gently pulling the quick release tab, then sliding the base toward the back of the device. See Figure 1, below.
2. Remove the battery door and insert a 9-volt battery.
3. Put battery back into compartment.
4. Replace the battery door (and mounting base if desired).

Figure 1: Attaching the mounting base

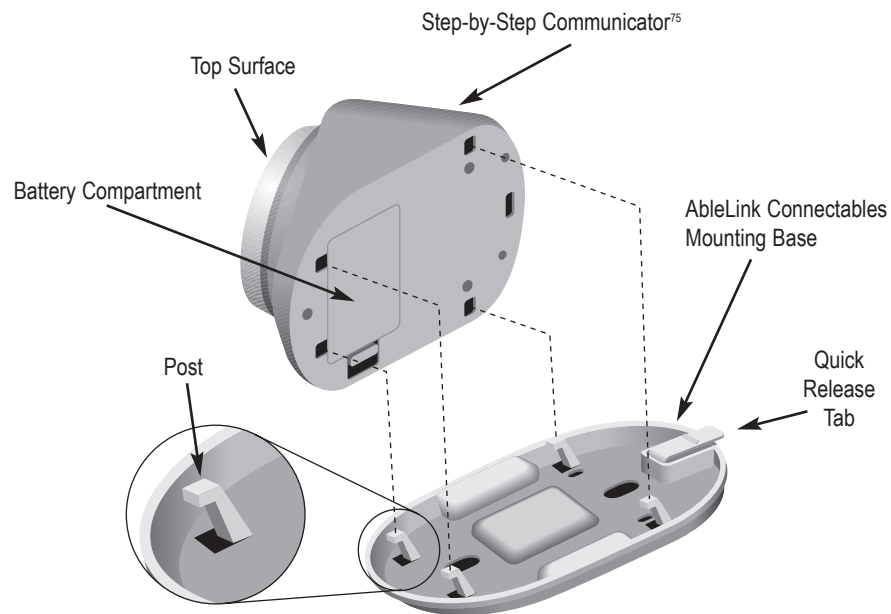

Recording a Message

The Step-by-Step Communicator⁷⁵ has 75 seconds of recording time. Please note that all messages must be recorded at one time. It is not possible to re-record or change just one message in the sequence of recorded messages without erasing all of the messages. It is recommended that you write down the messages and use a script during recording.

1. Turn on the Step-by-Step Communicator⁷⁵ by moving the volume control to the right until you hear a click.
2. Press the Repeat/Rec  button twice (within one second) and release.
3. Press and hold the top surface and record your first message. Hold the device 8-10" away from your mouth, with the speaker grille facing you.
4. Release the activation area briefly.
5. Press and hold the top surface and record your next message.
6. Repeat steps 4 and 5 until you have recorded all your messages.
7. Press the Repeat/Rec button twice to end recording.



For a convenient reference, use the "Quick Instructions" on the bottom of the Step-by-Step, when the manual is not available.

Playing the Message

1. Press the top surface of the Step-by-Step to play each message.
2. Messages will be played in the order they were recorded each time the activation area is pressed.
3. The message sequence loops back to the beginning after the last message has been played. Messages can also be played using an external switch (see page 5).

Repeating a Message

The "Repeat" function allows the user to replay any message in the sequence. For example, if the user is giving directions for a recipe, use the "Repeat" function to continue to play the message, "measure one cup of flour," until that step has been completed.

1. Play the messages until the message you want to repeat has been played.
2. Press the Repeat/Rec  button once.
3. Each time the top surface  is pressed, the message will repeat.
4. Press the Repeat/Rec button once to stop the repeat function and continue to play the rest of the recorded messages.

The "Repeat" function allows for storing pre-recorded single messages for one or more users. Locate desired message by pressing the activation area, use the "Repeat" function for the user to replay that specific message.

Toy/Appliance Jack

The Toy/Appl.  jack enables the user to communicate a message and control a battery or electrically-operated toy or appliance. This allows voice output to be paired with an activity. The Toy/Appl. function can be paired with as many messages as desired within a sequence.

Activating Battery-Operated Devices

A battery-operated toy or appliance may be attached directly to Step-by-Step using a battery device adapter and cable, or the cable may be plugged directly into a toy or appliance that has been pre-adapted.

Note: Using this direct connection, the toy or appliance will be activated when the message is played. If you wish the toy or appliance to run for a longer period of time, simply connect the cable from the Toy/Appl. jack to a Switch Latch and Timer and choose the Latch or Timed mode of control.

Activating Electrical Devices via PowerLink® control unit

Use a Step-by-Step to activate an electrically-operated appliance, toy or game by connecting it to a PowerLink® control unit. Plug the cable into the Step-by-Step Toy/Appl. jack and the other end into the switch input jack on the PowerLink® control unit and choose the Latch or Timed mode of control.

Using the Toy/Appl. Feature

1. Turn on the Step-by-Step Communicator⁷⁵ by moving the volume control to the right until you hear a click.
2. Press the Repeat/Rec button twice (within one second) and release.
3. Press and hold the top surface of the Step-by-Step to record the message.
4. While you are recording the message you want to pair with the toy/appliance, continue to hold the activation area and press/release the Repeat/Rec button once.
5. Release the activation area. Note: Additional messages may be added to complete the sequence.
6. Repeat steps 4-5 for each message you want to pair with the Toy/Appl. feature.
Note: When recording a message that you do not want to pair with a reinforcer, simply do not press the Repeat/Rec. button while the activation area is depressed.
7. When all of the messages have been recorded, and top surface is released, press the Repeat/Rec button twice to end recording.
8. Plug one end of the cable into the "Toy/Appl." jack of the Step-by-Step.
9. Plug the other end of the cable into the battery device adapter or pre-adapted toy or appliance if using a battery-operated device, or into the switch jack of the PowerLink® control unit if using an electrically-operated device.

Changing the Step-by-Step from activating a device for the length of a message (duration mode) to activating a device for a few seconds (pulse mode).

1. Make sure the device has been turned off for at least five minutes. Continue Steps 2-3 with the device turned off.
2. Press the top surface and continue to hold down.
3. Press the repeat/record button on the back of the device and continue to hold.
4. Turn on the device and then release the top surface and the repeat/record button at the same time.

To switch the device back to the duration mode, repeat the steps above.

On/Off Switch

When transporting Step-by-Step or when it is not in use, we recommend turning the volume knob completely down until it “clicks” into the off position to prevent accidental activation of the message and to extend battery life.

Using External Switches

Any commercially-available switch with a 1/8 inch (3.5 mm) plug or 1/8 inch mono plug adapter can be used to activate your Step-by-Step by plugging it into the external switch jack  on the back of the device. The user will then be able to activate the Step-by-Step with either the external switch or the top surface.

Mounting Options

There are several different mounting/positioning options for the Step-by-Step using the AbleLink™ Connectables mounting base. For more information about these mounting options see page 8.

Care and Storage

Your Step-by-Step will provide years of trouble-free service with a minimum of care. Recorded messages will be retained until new messages are recorded. A good quality battery can be expected to provide power to play back several hundred messages depending on their length. Wipe your Step-by-Step clean with a damp cloth or one with a little soap and water. Use water sparingly around the speaker grille and controls. **DO NOT IMMERSE IN WATER.**

Troubleshooting

If your Step-by-Step fails to operate properly, follow these suggestions. If the problem persists, call AbleNet at 1-800-322-0956 for assistance.

Problem	Solution
Step-by-Step fails to play message.	<ol style="list-style-type: none">1. Make sure the battery is fresh and is making contact.2. Be sure a message is recorded; record one if in doubt.3. Turn the volume control up to the highest volume during playback.4. If using an external switch, check to make sure it works independently of Step-by-Step.5. If using an external switch, make sure it is plugged into the correct jack on the Step-by-Step (SWITCH jack).
Only part of the message was recorded.	The message, or messages, were longer than 75 seconds. Re-record a shorter message(s), making sure to press the top surface firmly when recording.
Voice output gets distorted.	<ol style="list-style-type: none">1. The person recording may have been too close to the microphone while recording message. Either adjust the volume or re-record from 8 - 10 inches away.2. The battery may be getting low: replace battery.
A toy fails to operate when a message is played.	Check the toy to make sure it operates independently of the Toy/Appliance jack. Insure the 1/8" cable is securely connected to your Step-by-Step's Toy/Appl. jack. (Follow the steps for using the Toy/Appl. feature on page 4).
Speech slows down.	Replace battery.